

PERMIT TO CLOSE A HIGHWAY OR PART OF A HIGHWAY

In accordance with Section 19 of the Local Government (Highways Act) 1982 and, subject to the following terms and conditions, permission for the closure of a highway or part thereof for the purpose of conducting an event is granted to -

NAME: Matt Challis on behalf of **Tas Junior Cycling Foundation**
(hereinafter referred to as the Applicant)

ADDRESS: 10A Legana Park Drive, Legana TAS 7277

HIGHWAY TO BE CLOSED: **Tamar Street** between Brisbane Street and William Street
Cimitiere Street between Tamar Street and Racecourse Crescent
Racecourse Crescent between Cimitiere Street and Lyttleton Street
Lyttleton Street between Cimitiere Street and Elphin Road
Elphin Road between Lyttleton Street and Lawrence Street
Brisbane Street between Lawrence Street and Tamar Street
Lawrence Street between Cimitiere Street and Brisbane Street
Cameron Street at Tamar Street
Willis Street at Cimitiere Street
Cimitiere Street Lane at Cimitiere Street
Innes Street at Cimitiere Street
High Street at Elphin Road / Brisbane Street roundabout / intersection
Weymouth Street at Brisbane Street
(hereinafter referred to as the Highway)

EVENT: Gilmore Cycling Classic 2026

CLOSURE DATE & TIME: Sunday, 22 February 2026 from 10am to 3pm

PERSON RESPONSIBLE FOR TRAFFIC BARRIERS:
Viatic Traffic - Ellie Beadle - 0499 045 500
Matt Challis - Tas Junior Cycling Foundation - 0417 540 991

PERMIT CONDITIONS:

1. The Applicant is required to have permission from the Police Department to hold this event and, must accept any directions given by the Police or any authorised officer of the City of Launceston.
2. The Applicant must provide adequate control and supervision for the duration of the highway closure. Safe pedestrian access is to remain available to the public at all times.
3. Traffic control must be organised by person/s trained in Traffic Management and is to be in accordance with Australian Standard AS1742.3. Traffic management shall be installed in accordance with the plans submitted with this permit (as attached).
4. The Applicant is to ensure that a copy of the highway closure notice is displayed at points where the highway is closed.
5. The Applicant shall indemnify the City of Launceston and its officers from and against all actions, claims, penalties or demands consequent upon or arising out of, or occasioned by, any negligent act or default of the applicant or any person under the control of the applicant or any person whatever within the section of highway closed by this permit.
6. The Applicant shall, at all times during the Permit Term, be the holder of a current Public Liability Policy of insurance ("The Public Liability Policy") in respect of the activities specified herein in the name of the Applicant providing coverage for an amount of at least \$20M. The Public Liability Policy shall be effected

with an insurer approved by the City of Launceston. The Public Liability Policy shall cover such risks and be subject only to such conditions and exclusions as are approved by the City of Launceston and shall extend to cover the City of Launceston in respect to claims for personal injury or property damage arising out of the negligence of the Applicant.

7. The Applicant is to notify the public of the highway closure by way of advertising in the local newspaper on **Saturday, 14 February 2026**, the wording and format for the advertisement will be supplied by the City of Launceston.
8. The Applicant is to notify all properties on the streets affected by the road closure at least 7 days before the event.
9. The Applicant is to ensure that the highway is clean, undamaged and free from litter or debris that may have arisen from any activities whatsoever during the highway closure.



.....
Steve Tanchik
Team Leader - Transport

2/02/2026

.....
Date:

NOTE

SIGNAGE PLACEMENT IS A GUIDE ONLY
TRAFFIC CONTROLLERS TO PLACE SIGNS
IN BEST AND SAFEST LOCATION ON THE DAY

**BARRIER BOARDS AND/OR
CONES TO BE USED
AT ALL CLOSURES**

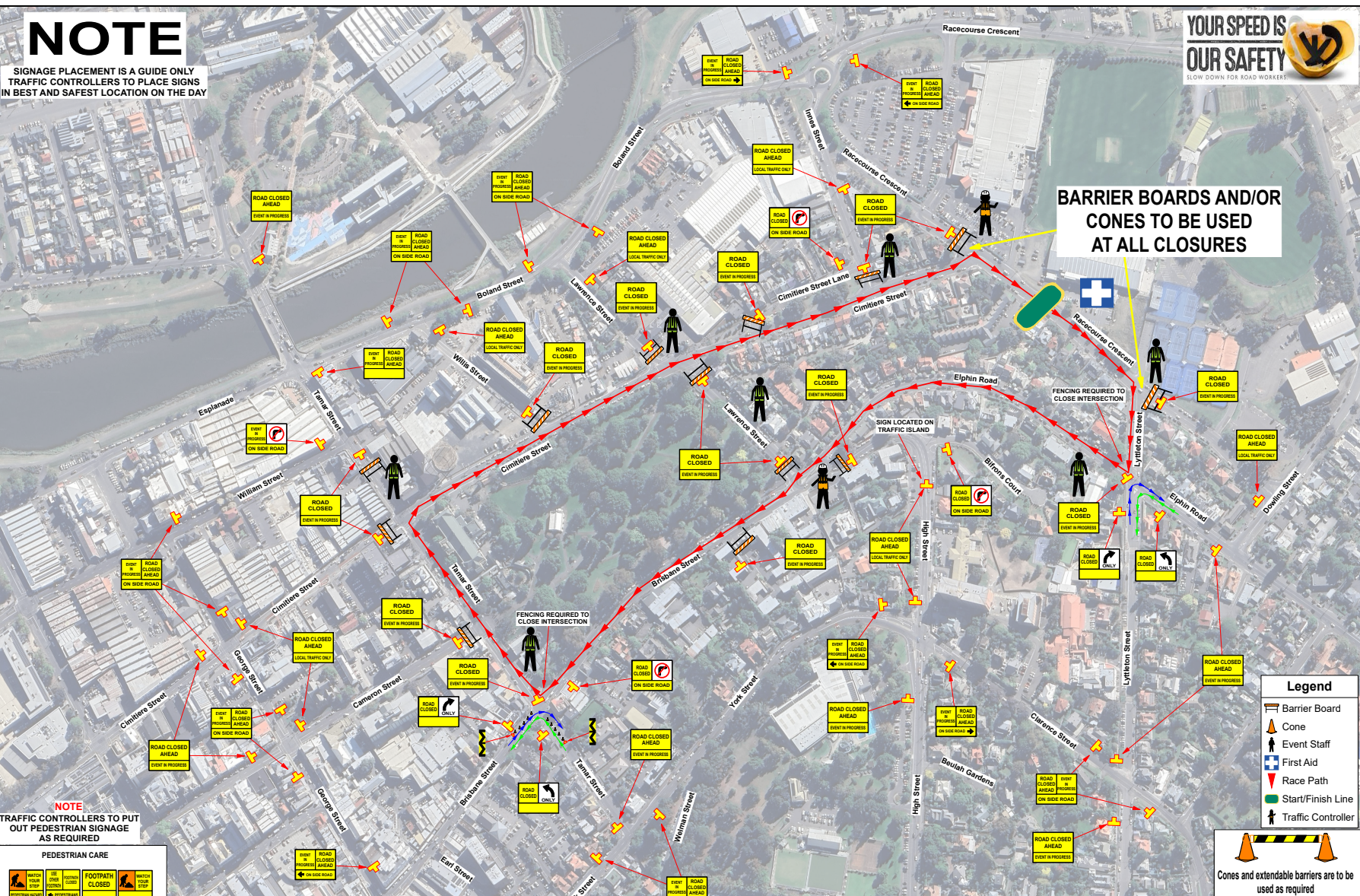

NOTE
TRAFFIC CONTROLLERS TO PUT
OUT PEDESTRIAN SIGNAGE
AS REQUIRED

PEDESTRIAN CARE



PEDESTRIAN SIGNAGE TO BE USED WHEN
WORK ZONE AFFECTS ANY PEDESTRIAN ROUTE

- Manfest**
- 1. Main Message (T2-43M Road Closed, M55-515-5-6-10 in Progress)
 - 1.6 Main Message (T6M-V107 Over in Progress, T2-125 On Side Road, T2-1033 Road Closed Ahead)
 - 1.7 Main Message (M55-AD20-23 Road Closed Ahead, M55-515-5-6-10 in Progress)
 - 1.8 Main Message (M55-AD20-23 Road Closed Ahead, M55-515-5-6-10 in Progress)
 - 1.9 Main Message (M55-AD20-23 Road Closed Ahead, M55-515-5-6-10 in Progress)
 - 2. Main Message (T2-43M Road Closed, T2-125 On Side Road, T2-1033 On Side Road)
 - 2.1 Main Message (T6M-V107 Over in Progress, T6M-1084 On Side Road, T2-1033 Road Closed Ahead)
 - 2.2 Main Message (T6M-V107 Over in Progress, T6M-1084 On Side Road, T2-1033 Road Closed Ahead)
 - 2.3 Main Message (T2-43M Road Closed, M55-515-5-6-10 in Progress, T6M-1084 On Side Road)
 - 2.4 Main Message (T6M-V107 Over in Progress, T6M-1084 On Side Road, T2-1033 Road Closed Ahead)
 - 2.5 Main Message (M55-AD20-23 Road Closed Ahead, M55-515-5-6-10 in Progress)
 - 2.6 Main Message (T6M-V107 Over in Progress, T2-125 On Side Road, T2-1033 On Side Road)
 - 2.7 Main Message (T6M-V107 Over in Progress, T6M-1084 On Side Road, T2-1033 Road Closed Ahead)
 - 2.8 Main Message (T6M-V107 Over in Progress, T6M-1084 On Side Road, T2-1033 Road Closed Ahead)
 - 2.9 Main Message (T6M-V107 Over in Progress, T6M-1084 On Side Road, T2-1033 Road Closed Ahead)
 - 2.10 Main Message (T6M-V107 Over in Progress, T6M-1084 On Side Road, T2-1033 Road Closed Ahead)
 - 2.11 Main Message (T6M-V107 Over in Progress, T6M-1084 On Side Road, T2-1033 Road Closed Ahead)
 - 2.12 Main Message (T6M-V107 Over in Progress, T6M-1084 On Side Road, T2-1033 Road Closed Ahead)
 - 2.13 Main Message (T6M-V107 Over in Progress, T6M-1084 On Side Road, T2-1033 Road Closed Ahead)
 - 2.14 Main Message (T6M-V107 Over in Progress, T6M-1084 On Side Road, T2-1033 Road Closed Ahead)
 - 2.15 Main Message (T6M-V107 Over in Progress, T6M-1084 On Side Road, T2-1033 Road Closed Ahead)
 - 2.16 Main Message (T6M-V107 Over in Progress, T6M-1084 On Side Road, T2-1033 Road Closed Ahead)
 - 2.17 Main Message (T6M-V107 Over in Progress, T6M-1084 On Side Road, T2-1033 Road Closed Ahead)
 - 2.18 Main Message (T6M-V107 Over in Progress, T6M-1084 On Side Road, T2-1033 Road Closed Ahead)
 - 2.19 Main Message (T6M-V107 Over in Progress, T6M-1084 On Side Road, T2-1033 Road Closed Ahead)
 - 2.20 Main Message (T6M-V107 Over in Progress, T6M-1084 On Side Road, T2-1033 Road Closed Ahead)
 - 2.21 Main Message (T6M-V107 Over in Progress, T6M-1084 On Side Road, T2-1033 Road Closed Ahead)
 - 2.22 Main Message (T6M-V107 Over in Progress, T6M-1084 On Side Road, T2-1033 Road Closed Ahead)
 - 2.23 Main Message (T6M-V107 Over in Progress, T6M-1084 On Side Road, T2-1033 Road Closed Ahead)
 - 2.24 Main Message (T6M-V107 Over in Progress, T6M-1084 On Side Road, T2-1033 Road Closed Ahead)
 - 2.25 Main Message (T6M-V107 Over in Progress, T6M-1084 On Side Road, T2-1033 Road Closed Ahead)
 - 2.26 Main Message (T6M-V107 Over in Progress, T6M-1084 On Side Road, T2-1033 Road Closed Ahead)
 - 2.27 Main Message (T6M-V107 Over in Progress, T6M-1084 On Side Road, T2-1033 Road Closed Ahead)
 - 2.28 Main Message (T6M-V107 Over in Progress, T6M-1084 On Side Road, T2-1033 Road Closed Ahead)
 - 2.29 Main Message (T6M-V107 Over in Progress, T6M-1084 On Side Road, T2-1033 Road Closed Ahead)
 - 2.30 Main Message (T6M-V107 Over in Progress, T6M-1084 On Side Road, T2-1033 Road Closed Ahead)
 - 2.31 Main Message (T6M-V107 Over in Progress, T6M-1084 On Side Road, T2-1033 Road Closed Ahead)
 - 2.32 Main Message (T6M-V107 Over in Progress, T6M-1084 On Side Road, T2-1033 Road Closed Ahead)
 - 2.33 Main Message (T6M-V107 Over in Progress, T6M-1084 On Side Road, T2-1033 Road Closed Ahead)
 - 2.34 Main Message (T6M-V107 Over in Progress, T6M-1084 On Side Road, T2-1033 Road Closed Ahead)
 - 2.35 Main Message (T6M-V107 Over in Progress, T6M-1084 On Side Road, T2-1033 Road Closed Ahead)
 - 2.36 Main Message (T6M-V107 Over in Progress, T6M-1084 On Side Road, T2-1033 Road Closed Ahead)
 - 2.37 Main Message (T6M-V107 Over in Progress, T6M-1084 On Side Road, T2-1033 Road Closed Ahead)
 - 2.38 Main Message (T6M-V107 Over in Progress, T6M-1084 On Side Road, T2-1033 Road Closed Ahead)
 - 2.39 Main Message (T6M-V107 Over in Progress, T6M-1084 On Side Road, T2-1033 Road Closed Ahead)
 - 2.40 Main Message (T6M-V107 Over in Progress, T6M-1084 On Side Road, T2-1033 Road Closed Ahead)
 - 2.41 Main Message (T6M-V107 Over in Progress, T6M-1084 On Side Road, T2-1033 Road Closed Ahead)
 - 2.42 Main Message (T6M-V107 Over in Progress, T6M-1084 On Side Road, T2-1033 Road Closed Ahead)
 - 2.43 Main Message (T6M-V107 Over in Progress, T6M-1084 On Side Road, T2-1033 Road Closed Ahead)
 - 2.44 Main Message (T6M-V107 Over in Progress, T6M-1084 On Side Road, T2-1033 Road Closed Ahead)
 - 2.45 Main Message (T6M-V107 Over in Progress, T6M-1084 On Side Road, T2-1033 Road Closed Ahead)
 - 2.46 Main Message (T6M-V107 Over in Progress, T6M-1084 On Side Road, T2-1033 Road Closed Ahead)
 - 2.47 Main Message (T6M-V107 Over in Progress, T6M-1084 On Side Road, T2-1033 Road Closed Ahead)
 - 2.48 Main Message (T6M-V107 Over in Progress, T6M-1084 On Side Road, T2-1033 Road Closed Ahead)
 - 2.49 Main Message (T6M-V107 Over in Progress, T6M-1084 On Side Road, T2-1033 Road Closed Ahead)
 - 2.50 Main Message (T6M-V107 Over in Progress, T6M-1084 On Side Road, T2-1033 Road Closed Ahead)
 - 2.51 Main Message (T6M-V107 Over in Progress, T6M-1084 On Side Road, T2-1033 Road Closed Ahead)
 - 2.52 Main Message (T6M-V107 Over in Progress, T6M-1084 On Side Road, T2-1033 Road Closed Ahead)
 - 2.53 Main Message (T6M-V107 Over in Progress, T6M-1084 On Side Road, T2-1033 Road Closed Ahead)
 - 2.54 Main Message (T6M-V107 Over in Progress, T6M-1084 On Side Road, T2-1033 Road Closed Ahead)
 - 2.55 Main Message (T6M-V107 Over in Progress, T6M-1084 On Side Road, T2-1033 Road Closed Ahead)
 - 2.56 Main Message (T6M-V107 Over in Progress, T6M-1084 On Side Road, T2-1033 Road Closed Ahead)
 - 2.57 Main Message (T6M-V107 Over in Progress, T6M-1084 On Side Road, T2-1033 Road Closed Ahead)
 - 2.58 Main Message (T6M-V107 Over in Progress, T6M-1084 On Side Road, T2-1033 Road Closed Ahead)
 - 2.59 Main Message (T6M-V107 Over in Progress, T6M-1084 On Side Road, T2-1033 Road Closed Ahead)
 - 2.60 Main Message (T6M-V107 Over in Progress, T6M-1084 On Side Road, T2-1033 Road Closed Ahead)
 - 2.61 Main Message (T6M-V107 Over in Progress, T6M-1084 On Side Road, T2-1033 Road Closed Ahead)
 - 2.62 Main Message (T6M-V107 Over in Progress, T6M-1084 On Side Road, T2-1033 Road Closed Ahead)
 - 2.63 Main Message (T6M-V107 Over in Progress, T6M-1084 On Side Road, T2-1033 Road Closed Ahead)
 - 2.64 Main Message (T6M-V107 Over in Progress, T6M-1084 On Side Road, T2-1033 Road Closed Ahead)
 - 2.65 Main Message (T6M-V107 Over in Progress, T6M-1084 On Side Road, T2-1033 Road Closed Ahead)
 - 2.66 Main Message (T6M-V107 Over in Progress, T6M-1084 On Side Road, T2-1033 Road Closed Ahead)
 - 2.67 Main Message (T6M-V107 Over in Progress, T6M-1084 On Side Road, T2-1033 Road Closed Ahead)
 - 2.68 Main Message (T6M-V107 Over in Progress, T6M-1084 On Side Road, T2-1033 Road Closed Ahead)
 - 2.69 Main Message (T6M-V107 Over in Progress, T6M-1084 On Side Road, T2-1033 Road Closed Ahead)
 - 2.70 Main Message (T6M-V107 Over in Progress, T6M-1084 On Side Road, T2-1033 Road Closed Ahead)
 - 2.71 Main Message (T6M-V107 Over in Progress, T6M-1084 On Side Road, T2-1033 Road Closed Ahead)
 - 2.72 Main Message (T6M-V107 Over in Progress, T6M-1084 On Side Road, T2-1033 Road Closed Ahead)
 - 2.73 Main Message (T6M-V107 Over in Progress, T6M-1084 On Side Road, T2-1033 Road Closed Ahead)
 - 2.74 Main Message (T6M-V107 Over in Progress, T6M-1084 On Side Road, T2-1033 Road Closed Ahead)
 - 2.75 Main Message (T6M-V107 Over in Progress, T6M-1084 On Side Road, T2-1033 Road Closed Ahead)
 - 2.76 Main Message (T6M-V107 Over in Progress, T6M-1084 On Side Road, T2-1033 Road Closed Ahead)
 - 2.77 Main Message (T6M-V107 Over in Progress, T6M-1084 On Side Road, T2-1033 Road Closed Ahead)
 - 2.78 Main Message (T6M-V107 Over in Progress, T6M-1084 On Side Road, T2-1033 Road Closed Ahead)
 - 2.79 Main Message (T6M-V107 Over in Progress, T6M-1084 On Side Road, T2-1033 Road Closed Ahead)
 - 2.80 Main Message (T6M-V107 Over in Progress, T6M-1084 On Side Road, T2-1033 Road Closed Ahead)
 - 2.81 Main Message (T6M-V107 Over in Progress, T6M-1084 On Side Road, T2-1033 Road Closed Ahead)
 - 2.82 Main Message (T6M-V107 Over in Progress, T6M-1084 On Side Road, T2-1033 Road Closed Ahead)
 - 2.83 Main Message (T6M-V107 Over in Progress, T6M-1084 On Side Road, T2-1033 Road Closed Ahead)
 - 2.84 Main Message (T6M-V107 Over in Progress, T6M-1084 On Side Road, T2-1033 Road Closed Ahead)
 - 2.85 Main Message (T6M-V107 Over in Progress, T6M-1084 On Side Road, T2-1033 Road Closed Ahead)
 - 2.86 Main Message (T6M-V107 Over in Progress, T6M-1084 On Side Road, T2-1033 Road Closed Ahead)
 - 2.87 Main Message (T6M-V107 Over in Progress, T6M-1084 On Side Road, T2-1033 Road Closed Ahead)
 - 2.88 Main Message (T6M-V107 Over in Progress, T6M-1084 On Side Road, T2-1033 Road Closed Ahead)
 - 2.89 Main Message (T6M-V107 Over in Progress, T6M-1084 On Side Road, T2-1033 Road Closed Ahead)
 - 2.90 Main Message (T6M-V107 Over in Progress, T6M-1084 On Side Road, T2-1033 Road Closed Ahead)
 - 2.91 Main Message (T6M-V107 Over in Progress, T6M-1084 On Side Road, T2-1033 Road Closed Ahead)
 - 2.92 Main Message (T6M-V107 Over in Progress, T6M-1084 On Side Road, T2-1033 Road Closed Ahead)
 - 2.93 Main Message (T6M-V107 Over in Progress, T6M-1084 On Side Road, T2-1033 Road Closed Ahead)
 - 2.94 Main Message (T6M-V107 Over in Progress, T6M-1084 On Side Road, T2-1033 Road Closed Ahead)
 - 2.95 Main Message (T6M-V107 Over in Progress, T6M-1084 On Side Road, T2-1033 Road Closed Ahead)
 - 2.96 Main Message (T6M-V107 Over in Progress, T6M-1084 On Side Road, T2-1033 Road Closed Ahead)
 - 2.97 Main Message (T6M-V107 Over in Progress, T6M-1084 On Side Road, T2-1033 Road Closed Ahead)
 - 2.98 Main Message (T6M-V107 Over in Progress, T6M-1084 On Side Road, T2-1033 Road Closed Ahead)
 - 2.99 Main Message (T6M-V107 Over in Progress, T6M-1084 On Side Road, T2-1033 Road Closed Ahead)
 - 3. Main Message (T6M-V107 Over in Progress, T6M-1084 On Side Road, T2-1033 Road Closed Ahead)

Although the optimal option for design parameters should be used as often as possible, it is recognized by ACT that the ultimate control of all situations is the designer's responsibility to assess or develop the traffic management required to suit the conditions and the scope of works (P2020). A safety buffer shall be provided immediately in advance of the work area where the speed is 50 km/h or higher. An advance of 20m to 30m in length is generally sufficient. There is a difference on signage distance being 10% less than the distance spacing listed or 20% more than the spacing listed. The advanced time and placement is determined by the first party in any local electrical or physical world the adjustments from Viatec Traffic Solutions.

Legend

- Barrier Board
- Cone
- Event Staff
- First Aid
- Race Path
- Start/Finish Line
- Traffic Controller



Cones and extendable barriers are to be used as required

TGS Description:
Event in progress - Gilmore Cycling Club Full Road Closure Implemented

Author: E. Beattie Cert #: T6M-1084-07260 O: Scale: NTS
 Drawn: E. Beattie T6M-1084-07260 O: Date: 19-11-2025

ISO 14001
Environment

ISO 9001
Quality

ISO 45001
Occupational Health & Safety

Client: **Fairbrother**

TGS Plan #: 392 TFP Plan #: N/A Client Job #: 225883

DISCLAIMER

This Traffic Guidance Scheme (TGS) has been prepared as a guide for Temporary Traffic Management. It is not intended to be used as a substitute for professional advice. The user of this TGS is responsible for ensuring that it is used in accordance with the relevant standards and codes of practice. The user of this TGS is responsible for ensuring that it is used in accordance with the relevant standards and codes of practice. The user of this TGS is responsible for ensuring that it is used in accordance with the relevant standards and codes of practice.